

Randolph County Developments

A Publication of the Randolph County Economic Development Corporation

September 2022

North Carolina: #1 For Business

The Old North State was recently declared the Top State for Business by [CNBC's](#) annual state competitiveness rankings. North Carolina has been in the Top 10 almost every year since the study's inception in 2007, but this was the first year North Carolina claimed the top spot. CNBC points out that by "putting partisanship aside" and "powered by an economy that has hit its stride, and turbocharged by a long track record of innovation", North Carolina has built the nation's strongest economy. The State's economy grew at a formidable 6.7% last year and jobs grew at a significant 3.6%, both among the strongest in the Nation. Announcements like the Toyota battery plant are spurring the next generation in North Carolina's long history of manufacturing; bringing with it well-paying, family-sustaining jobs. Needless to say, it is an exciting time in North Carolina, especially here in Randolph County.

Business News & Announcements



Häfele, a German furniture hardware component manufacturer, has [begun](#) work on the expansion of its Archdale distribution center. Once complete, the facility will comprise 221,000 square feet and increase capacity by 60%. This expansion represents a capital investment of \$13 million and is expected to add 15 jobs. The project will also include a 501 kW solar system, consisting of more than 1,100 panels and providing approximately 75% of needed power.



We would like to congratulate David Cybulski on being [named](#) the new President and CEO of **Klaussner Home Furnishings**. Cybulski joined Asheboro, NC-based Klaussner Home Furnishings as CFO three years ago and became interim CEO upon the retirement of Terry McNew. Regarding his new position, Cybulski stated, "In my new role as CEO, I look forward to working with our leadership team, dealers and suppliers as we continue to build on Klaussner's legacy of innovation and customer service."

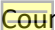

Sapona Plastics, based in Randolph County, has [consolidated](#) ownership and is now wholly owned by JBDJ, LLC. The management team remains largely unchanged apart from President Dean Lail becoming CEO, and his father Jack Lail moving into the role of Chairman. This move will allow Sapona to continue to grow locally. Sapona plans to add injection molding operations at Plant 2 in Seagrove in the coming year, which is expected to create more than 20 new jobs. These 20 new jobs are in addition to the 120 employees that Sapona employs at two plants in Randolph  County.



TOYOTA

Toyota has [announced](#) an increase in capital investment and jobs to its electric vehicle battery plant in Liberty. Toyota will invest an additional \$2.5B and create 350 more jobs at the site, bringing the total investment to \$3.8B and approximately 2,100 jobs. The additional investment provides greater capacity to support the production of battery-electric vehicles or BEVs. Toyota North America's senior vice president for Unit Manufacturing and Engineering stated, "As we continue to watch the marketplace a little bit and we see that conversion going, we feel like we've got to get ready, and the time to do that is now."

Did you Know?

October is our second annual **Industry Appreciation Month!**

The EDC is gearing up for Industry Appreciation Month and is excited about all the upcoming events including plant tours, the forklift rodeo, and more. The EDC will be asking the Randolph County Commissioners for an Official Declaration of October as Industry Appreciation **Month**. We encourage all our local industry partners to be on the lookout for more details as we get closer to October.



Pictured above: Last year's Forklift Rodeo Participants

Randolph EDC News

RCEDC held its annual meeting in early August at Pinewood Country Club and celebrated a banner year for the county. Although it was a new venue and new time, the meeting was a great success. Representatives from the two largest projects of the past year, Toyota and Technimark, attended the meeting and spoke about the planned developments. We thank them and all our industry partners for attending.

RCEDC would also like to announce changes to the Board of Directors. Shelley Greene from Randolph Community College and Diane James from Hubbell Industrial Controls were re-appointed to the Board and Frank Edmondson from Schwarz properties was newly appointed. We are excited to work with these wonderful local leaders. Todd Schwarz from Schwarz Properties has rotated off the Board and we would like to thank him for his time and commitment to Randolph EDC and to Randolph County. Finally, we thank Scott Darr for his work this past year as Board Chair, and we would like to welcome Bob Crumley as the new Board Chair for the 22/23 FY.

The RCEDC continues to work with Randolph County, the City of Randleman, and the City of Asheboro to develop a 160-acre industrial park just off Interstate 74 and Hwy. 311 in Sophia. Much due diligence has been completed and the next step is extension of water and sewer to the site. The sewer line design is 50% complete, the waterline design is underway, and NCDOT will begin the design of roadway improvements soon. The future industrial park will provide much-needed site inventory for the EDC market to potential new manufacturing and distribution companies and will provide a competitive advantage in winning projects. See an initial conceptual design below.

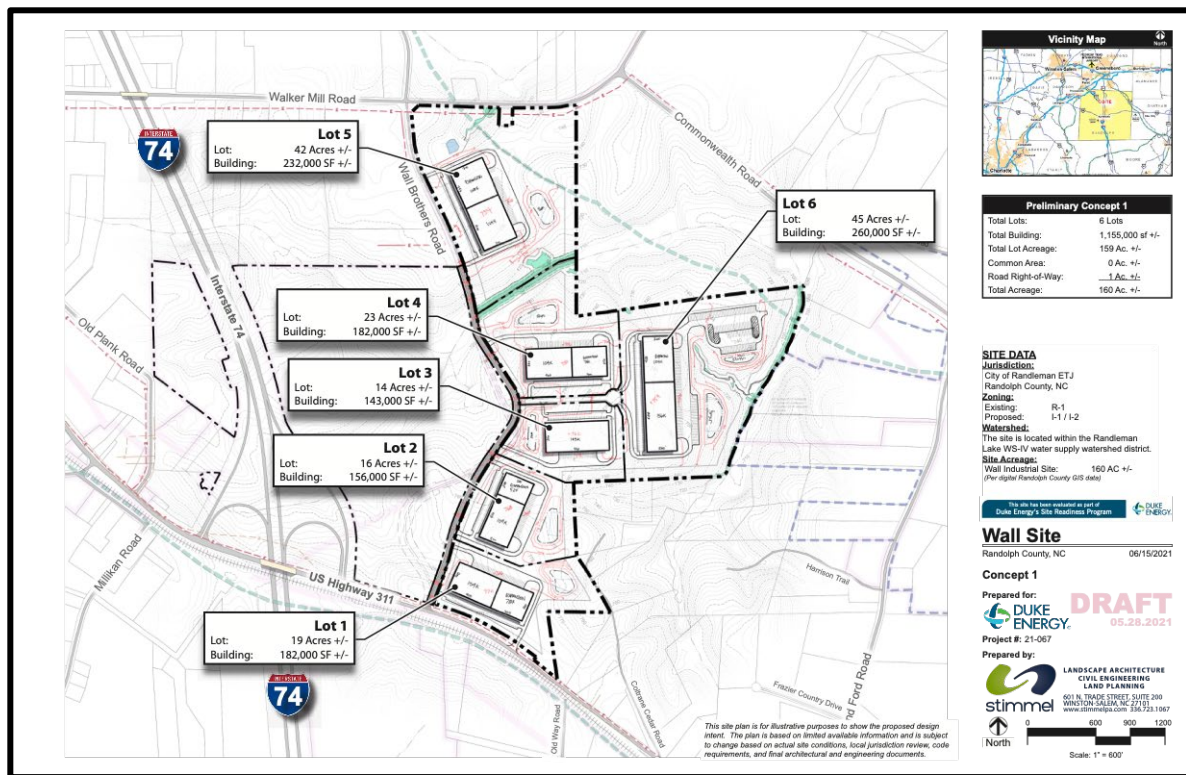

Congratulations are in order for Lisa Bennett who celebrated her 20-year work anniversary with the EDC on April 22nd. Bennett, the EDC's Manager of Marketing and Research, does all that and much more. She has worked tirelessly under three EDC presidents, one of whom appropriately referred to her as the glue that holds the organization together. At the EDC's April meeting, Bennett was recognized by the Board of Directors for her many years of dedicated service to the organization and the community.



The RCEDC is excited to announce its first-ever Intern. The EDC recently brought on Brantley Craft, a second-year Master of Public Administration student at UNCG, concentrating on Economic Development. Craft is a Greensboro native and spent this past summer interning with the Greensboro Chamber of Commerce's Economic Development Team. We are excited to welcome him to the EDC and Randolph County and look forward to working with him for the 22-23 school year. When not at school or work, you may find Craft out hiking trails across the Piedmont and he is especially fond of our local Uwharrie National Forest.

EDC Partnership News

The Randolph County Partnership is the member organization of the EDC. Through annual dues, our members invest in economic development in Randolph County by supporting marketing, recruitment, existing business and industry services, and industrial product development. Partner members are [listed on the EDC website](#), included in existing business and industry directories, and they benefit from services and referrals from the EDC.

We greatly appreciate recent **Partnership renewals** by the companies listed below. We currently have 114 [private sector members](#) and would welcome new partners. Please direct membership inquiries to Lisa Bennett at 336-626-2233 or lbennett@rcedc.com.

We'd like to recognize and welcome our newest Partners:

Bronze Partners: Skill Werx, LLC and Stonetree Signs/ Line Drive Graphics. [Stonetree Signs/](#) Line Drive Graphics provides quality printing and sign products for businesses and organizations across the area. Skill Werx, LLC provides workforce development consulting services and solutions to our area.

Silver Partners: **Sanford Contractors, Inc.** and the **Ramseur Eastern Randolph Area Chamber of Commerce**. [Sanford Contractors](#) provides an array of construction services including bridge construction, site development, utility construction, and more. The [Ramseur Eastern Randolph Area Chamber of Commerce](#) advocates for, connects, and encourages business growth in the eastern part of our county.

Diamond (\$2,500)

Ace/Avant Concrete Construction, Inc.

Platinum (\$1,000)

J.P. Thomas & Co., Inc.

Gold (\$1,000)

Sapona Plastics

Silver (\$500)

Fidelity Bank
Pinnacle Financial Partners
Randolph Communications
RC Tourism Authority/Heart of NC Visitors
Bureau

Bronze (\$250)

Advisors Financial Center, LLP
Brubaker & Associates, Inc.
Commonwealth Hosiery Mills, Inc.
Manhattan American Terrazzo Strip
Powder Works, Inc.
RE/MAX Central Realty
Ridge Funeral Home & Cremation Service
Wayne Thomas Chevrolet

Randolph County Economic Development Corporation
176 N. Fayetteville St. | Asheboro, NC 27203
336-626-2233 | www.rcedc.com
[@Randolph_EDC](#) | facebook.com/RandolphEDC

